

DIE & MOLD END MILLS



CONICALTM

DIE SINK CUTTERS



AMERICAN
MADE



GLOBALLY
RENOWNED

DIE & MOLD END MILLS
FOR PLUNGE OPENING HOLES & SLOTTING RUNNER CHANNELS





CONICALTM

DIE SINK CUTTERS

PLUNGING & SLOTTING

IN ALL MATERIALS

FEATURES & BENEFITS

Conical Die Sinks have a versatile design to be used in multiple processes in die and mold manufacturing. They have the versatility to plunge, taper existing holes, machine runners and act as a burr removal tool whenever necessary. The Global way is to go above and beyond current standards in the market, whenever possible. That's why you will find the Conical Die Sink end mill with a larger core, high strength flute design and premium micro-grain carbide, which maintains all our products as the last word in value.

General Inquiries:

P: (616) 531-8500
F: (616) 531-7742
E: info@conicaltool.com

Sales & Distribution:

T: (888) 531-8500
E: sales@conicaltool.com

Custom Tooling:

E: quotes@conicaltool.com
W: conicalendmills.com/custom-tool-ordering



CONICALTM

CUTTING TOOLS

SERIES: DSX

Designed for plunge opening tapered holes in molds and die, contour finishing of details in cavities and slotting of runner channels and gates.

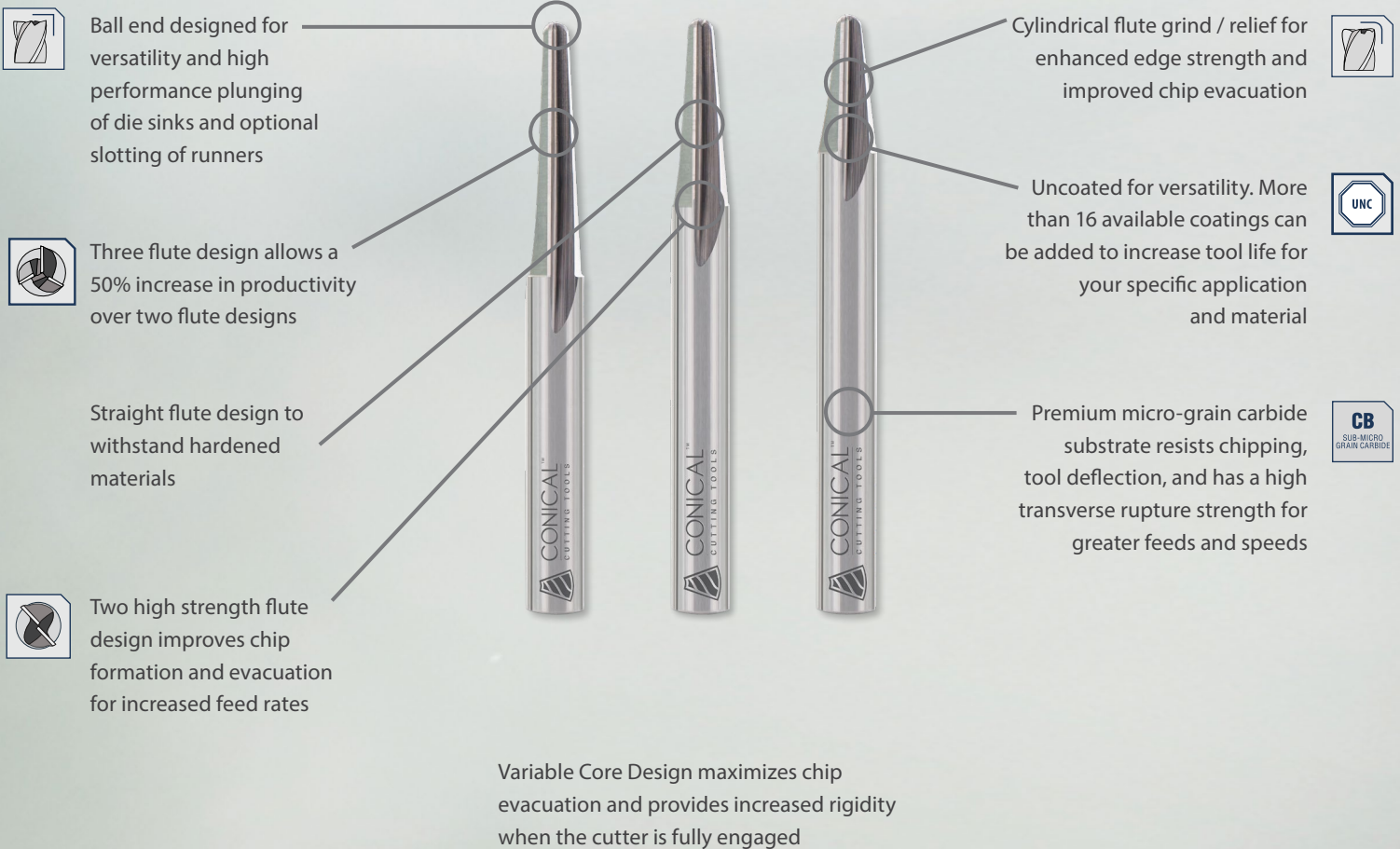

TIP & END



SHANK & LENGTH



FLUTE CONFIGURATION



MATERIAL



COATING



RESULTS

The neutral rake angle provides superior chip evacuation and protects the tool edge when machining difficult materials. Whether plunging, slotting or making runners in hardened material, the Conical Die Sink performs amazingly well, as a result of our advanced engineering.

When ferrous material and aluminum are on the machine, this will be your tool of choice. The two flute design clears chips quickly and leaves the finished product for your approval.

Series DSX: Micro-Grain Carbide, 2 & 3 Straight Flutes

Subseries: DS203, DS205, DS207, DS303, DS305, DS307

Configuration: Varying Angles; Varying Diameters; Regular Length;
2 & 3 Straight Flutes; Ball End

DIE SINKS

CONICAL™

SERIES DSX - CARBIDE, 2 STRAIGHT FLUTES

VERSATILITY

Our Conical Die Sinks have the versatility to plunge, taper existing holes, machine runners and act as a burr removal tool whenever necessary. A three flute configuration is available for enhanced productivity in easy to machine materials.

- Ball end designed for versatility and high performance plunging of die sinks and optional slotting of runners
- Two high strength flute design improves chip formation and evacuation for increased feed rates
- Cylindrical flute grind / relief for enhanced edge strength and improved chip evacuation

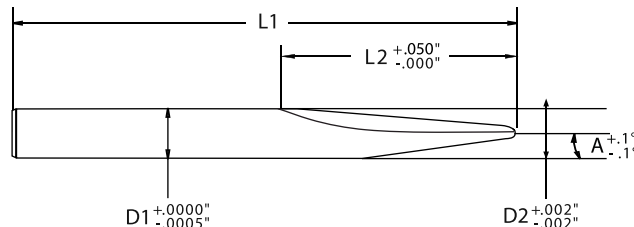

To order a corner radius, use code "CR" & actual radius in the part number. For example, a standard AX-203 would be ordered as AX-203-CR-015, with "015" being the radius.

TIP & END



SHANK & LENGTH



FLUTE CONFIGURATION

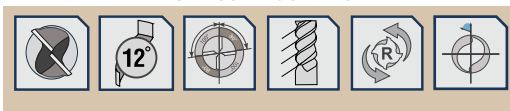

MATERIAL



COATING



SERIES DS203 - 3 DEGREE, BALL END, VARYING LENGTHS



ANGLE PER SIDE (A)	CORNER RADIUS (R)		BALL END DIAMETER (D2)		SHANK DIAMETER (D1)		FLUTE LENGTH (L2)		OVERALL LENGTH (L1)		# OF FLUTES	UNCOATED	
												PART #	EDP #
3° / 6°	1/64	0.016	1/32	0.031	1/8	0.125	7/8	0.875	2	2.000	2	DS2-C0001	DC01B
	1/32	0.031	1/16	0.063	1/8	0.125	9/16	0.563	2	2.000		DS2-C001	DC02B
					3/16	0.188	1	1.000	2	2.000		DS2-C002	DC03B
					1/4	0.250	1 1/2	1.500	2 1/2	2.500		DS2-C003	DC04B
	1/16	0.063	1/8	0.125	1/4	0.250	1	1.000	2 1/2	2.500		DS2-C201	DC05B

SERIES DS205 - 5 DEGREE, BALL END, VARYING LENGTHS



ANGLE PER SIDE (A)	CORNER RADIUS (R)		BALL END DIAMETER (D2)		SHANK DIAMETER (D1)		FLUTE LENGTH (L2)		OVERALL LENGTH (L1)		# OF FLUTES	UNCOATED	
												PART #	EDP #
5° / 10°	1/64	0.016	1/32	0.031	1/8	0.125	1/2	0.500	2	2.000	2	DS2-E0001	DE01B
	1/32	0.031	1/16	0.063	1/8	0.125	3/8	0.375	2	2.000		DS2-E001	DE02B
					3/16	0.188	1 1/16	0.688	2	2.000		DS2-E002	DE03B
					1/4	0.250	1 1/16	1.063	2 1/2	2.500		DS2-E003	DE04B
	1/16	0.063	1/8	0.125	1/4	0.250	1 1/16	0.688	2 1/2	2.500		DS2-E201	DE05B

SERIES DS207 - 7 DEGREE, BALL END, VARYING LENGTHS



ANGLE PER SIDE (A)	CORNER RADIUS (R)		BALL END DIAMETER (D2)		SHANK DIAMETER (D1)		FLUTE LENGTH (L2)		OVERALL LENGTH (L1)		# OF FLUTES	UNCOATED	
												PART #	EDP #
7° / 14°	1/64	0.016	1/32	0.031	1/8	0.125	3/8	0.375	2	2.000	2	DS2-G0001	DG01B
	1/32	0.031	1/16	0.063	1/8	0.125	1/4	0.250	2	2.000		DS2-G001	DG02B
					3/16	0.188	1/2	0.500	2	2.000		DS2-G002	DG03B
					1/4	0.250	3/4	0.750	2 1/2	2.500		DS2-G003	DG04B
					3/16	0.188	3/8	0.375	2	2.000		DS2-G101	DG05B
	1/16	0.063	1/8	0.125	1/4	0.250	1/2	0.500	2 1/2	2.500		DS2-G201	DG06B
	3/32	0.094	3/16	0.188	3/8	0.375	3/4	0.750	2 1/2	2.500		DS2-G301	DG07B
	1/8	0.125	1/4	0.250	1/2	0.500	1	1.000	3	3.000		DS2-G401	DG08B

SERIES DSX - CARBIDE, 3 STRAIGHT FLUTES

WITHSTANDING ANY TEST

Uncoated for versatility and have over 16 coatings that can be added to increase tool life. Rigidity is enhanced by the straight flute design, variable core and cylindrical flute, which together create a tool that will stand the tests of any machine process and material.

- Uncoated for versatility. More than 16 available coatings can be added to increase tool life for your specific application and material
- Premium micro-grain carbide substrate resists chipping, tool deflection, and has a high transverse rupture strength for greater feeds and speeds
- Variable Core Design maximizes chip evacuation and provides increased rigidity when the cutter is fully engaged

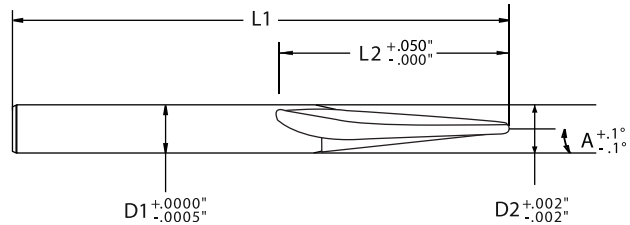

To order a corner radius, use code "CR" & actual radius in the part number. For example, a standard AX-203 would be ordered as AX-203-CR-015, with "015" being the radius.

TIP & END	SHANK & LENGTH	FLUTE CONFIGURATION	MATERIAL	COATING



70 YEARS OF INNOVATION



UNCOMPROMISING VALUE

The Conical Die Sink end mills add flexibility and versatility to our massive line of available in stock specialty die and mold cutters. To accomplish precisely plunged holes and slot runner channels, in any material, these end mills come in a vast array of flute, end and angle configurations.

Our Conical Die Sinks come uncoated for versatility and have over 16 coatings that can be added to increase tool life, based on your specific application and

workpiece material. Rigidity is enhanced by the straight flute design, variable core and cylindrical flute, which together create a tool that will stand the tests of any machine process and material. A three flute configuration is available for enhanced productivity in easy to machine materials.

This tool tackles everything from plunge opening tapered holes in molds and dies, to slotting runner channels and gates. The Conical Die Sink end mill guarantees versatility, without compromising value.

PERFORMANCE WE STAND BEHIND

We offer our 30 day return policy on standard and non-modified stock tools. Not because it's an industry standard practice, but because we know our tools and our customers rarely need it. We will take unused tools back after evaluation for as long as the tool line remains unchanged. We stand behind our tools and support them through their entire use cycle, which in our case, is a very long time.

Global Cutting Tools
Conical Tool Company

3890 Buchanan Ave SW
Grand Rapids, MI 49548

T: 888.531.8500 | P: 616.531.8500
F: 616.531.7742 | E: info@conicaltool.com

W: www.conicalendmills.com
W: www.globalcuttingtools.com



Conical Tool Company products are distributed by:

**OVER 7,000
DISTRIBUTORS WORLDWIDE**



Made in the U.S.A.